

# FLOOR PLANS OVERVIEW

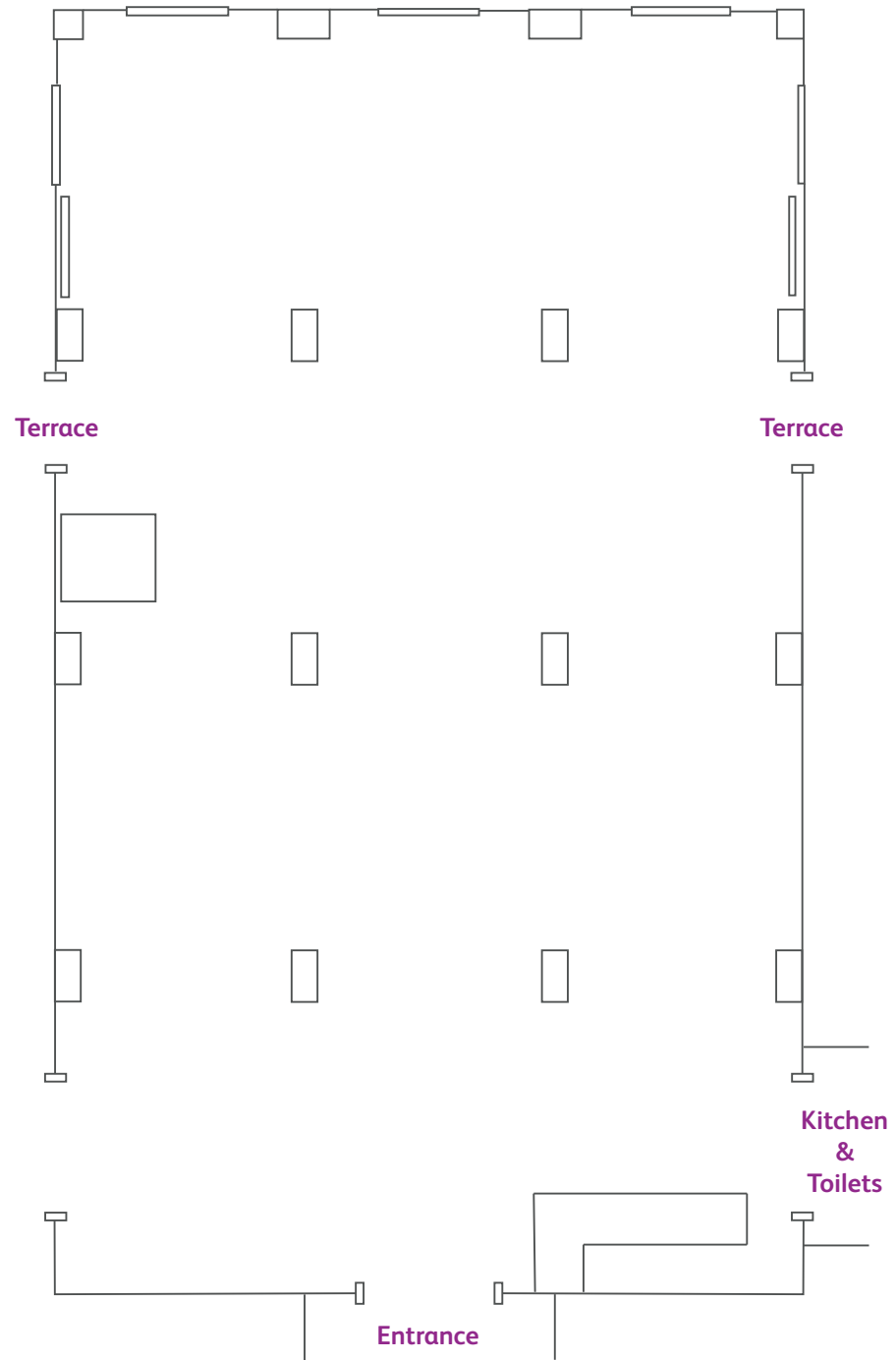

## Banquet



## Theatre Style



## Standing



# EAST WING FLOOR PLAN

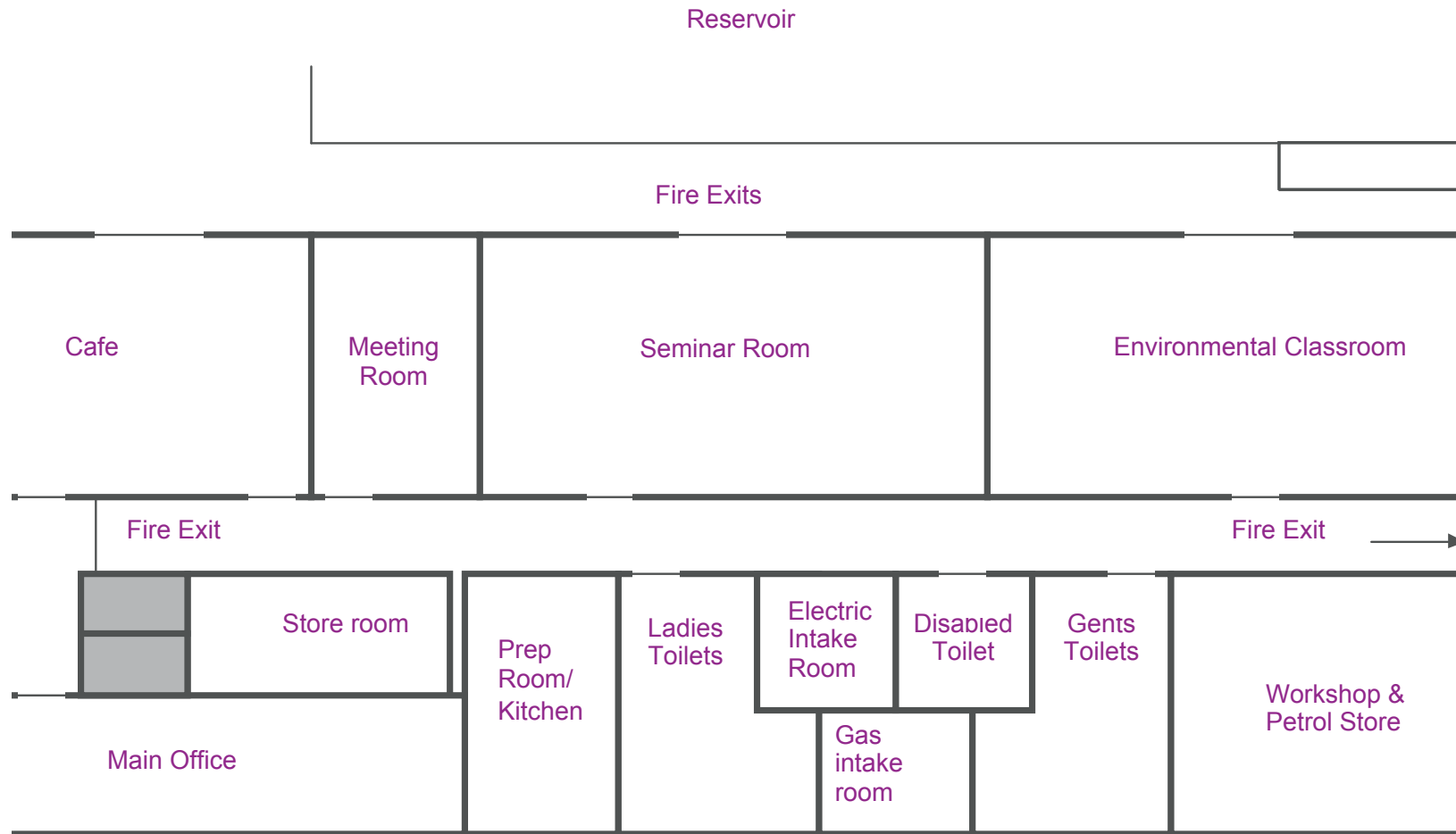

## EAST WING

### Seminar & lecture rooms

60 standing  
40 seated/cabaret  
50 theatre/conference

# WEST WING FLOOR PLAN

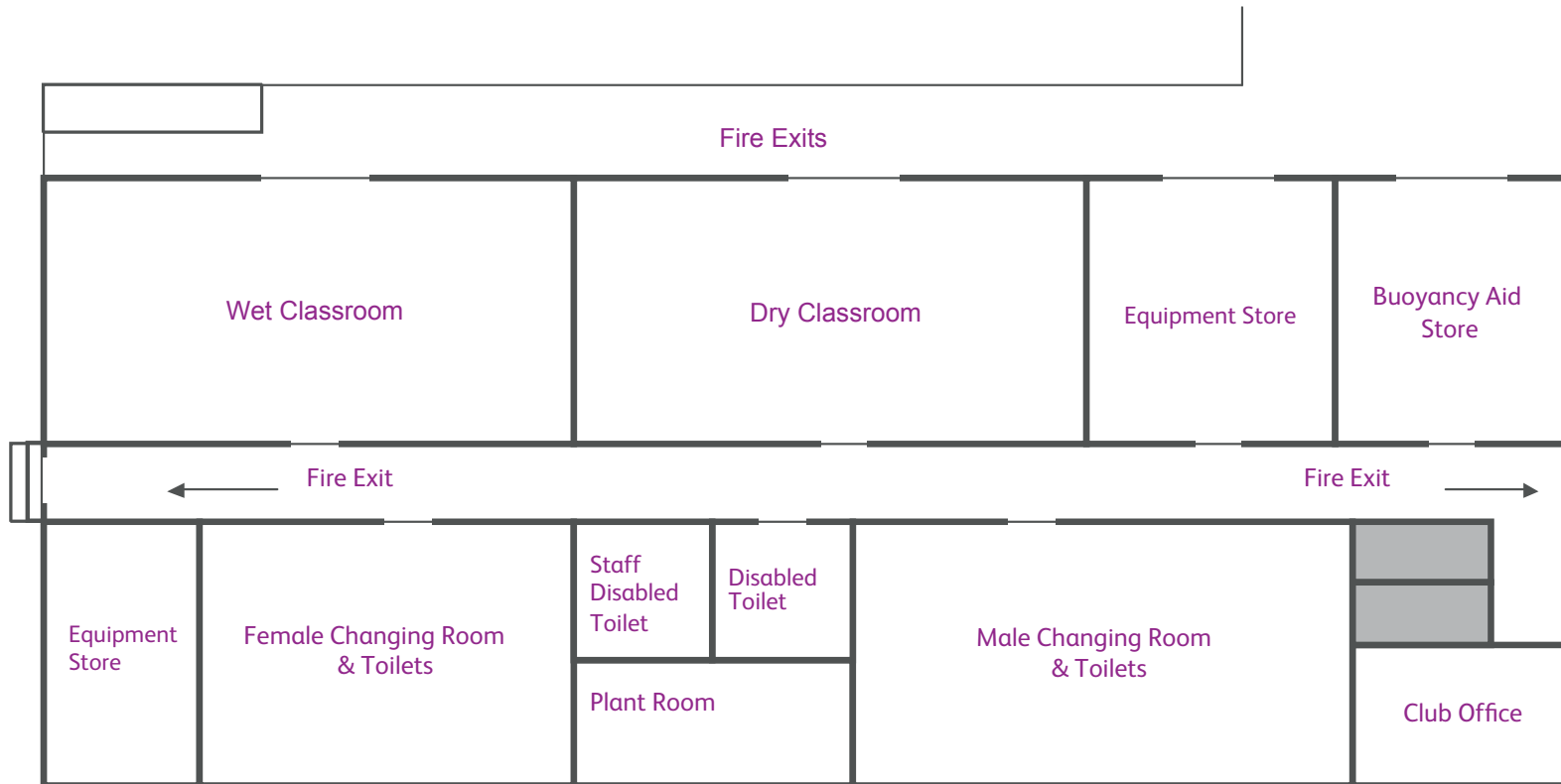

**o**  
**BETTER**

the feel good place